

## HEAT EXCHANGER REPLACEMENT Gas-fired indoor gravity duct furnace models DFG, IFG and NFG

**Figure 1.1**  
**Indoor Duct Furnace Exploded View**

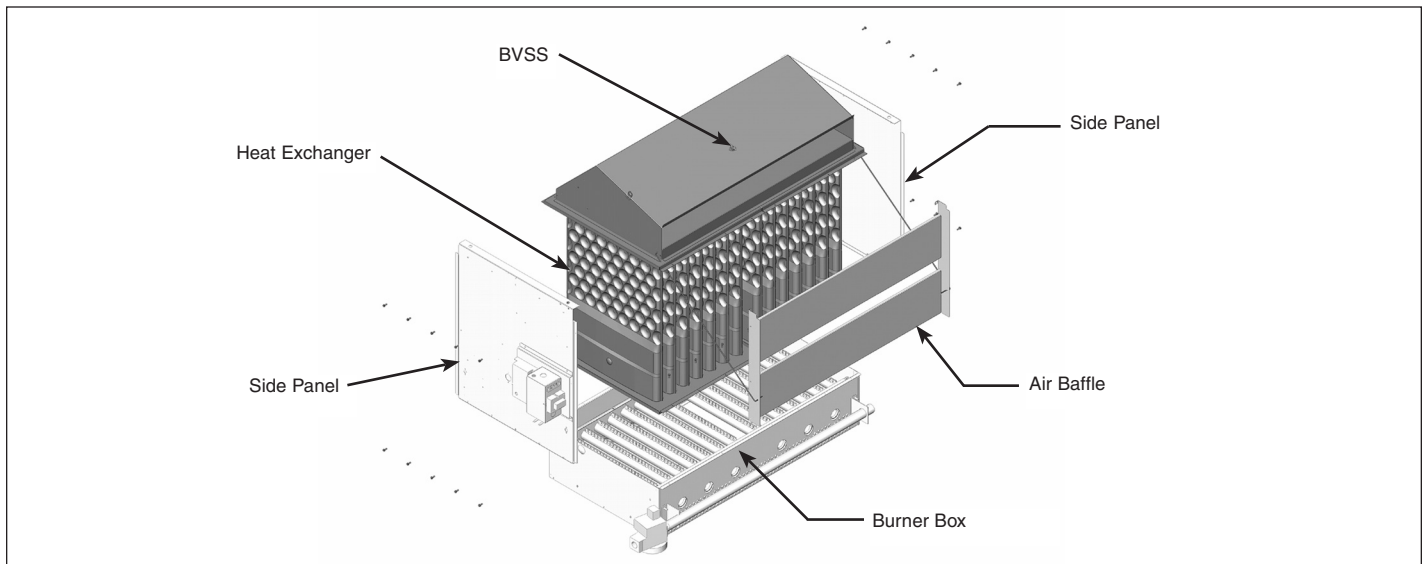

### **! WARNING**

1. Improper installation, adjustment, alteration, service or maintenance can cause property damage, injury or death, and could cause exposure to substances which have been determined by various state agencies to cause cancer, birth defects, or other reproductive harm. Read the installation, operating, and maintenance instructions thoroughly before installing or servicing this equipment.
2. The installation and maintenance instructions in the appliance manual as well as the following supplemental information must be followed to provide safe, efficient and trouble-free operation. In addition, particular care must be exercised regarding the special precautions listed on page 2 of the appliance Installation and Service Manual. Failure to properly address these critical areas could result in property damage or loss, personal injury, or death. These instructions are subject to any more restrictive local or national codes.
3. The listed conversion must be made prior to the installation of unit.
4. All units must be wired strictly in accordance with the wiring diagram furnished with the unit. Any wiring different from the wiring diagram could result in a hazard to persons and property.
5. All wiring must be done with a wiring material having a temperature rating of at least 105°C.

### **IMPORTANT**

The use of this manual is specifically intended for a qualified installation and service agency. All installation and service of these units must be performed by a qualified installation and service agency. Modine manuals may contain excerpts from component supplier literature adapted for Modine products. Any accompanying component supplier literature is for general information.

- Un-install the unit prior to heat exchanger replacement. Refer to the installation and service manual for installation instructions and perform in reverse order.
1. Disconnect the wires from the blocked vent safety switch (BVSS) located on the top of the unit (Fig 1.1).
  2. Remove BVSS wire harness assembly (with wires from step 1 intact) from top-side of unit by removing harness mounting screw.
  3. Remove all sheet metal screws that secure the left and right side panels (Fig 1.1) to the heat exchanger. Carefully remove these side panels paying special attention not to damage the electrical controls or wiring.
  4. Remove all sheet metal screws that secure the heat exchanger to the burner box assembly.
  5. Lift out and replace the heat exchanger.
  6. Replace screws to secure heat exchanger to burner box.

7. Add fiberglass tape to sides of heat exchanger top and bottom headers (per Fig 1.1).
8. Replace side panels to sides of heat exchanger and secure with sheet metal screws removed earlier. Screws will penetrate fiberglass tape.
9. Reattach wire harness assembly to original position and reconnect wires to BVSS.
10. Inspect all wiring, controls, and parts for damage during unit modification.
11. Ensure that all sheet metal screws are tight and located in their original location.
12. Confirm that the unit is wired according to the wiring diagram supplied with the unit.
13. Ensure that the air baffle is located on the air inlet side of the furnace if it is required.
14. Continue with the installation instructions listed in 5-561.